

Number	RevA	RevB	Height	Length	Centres	Lintels	Nailing	Quantity
EXT001			2395	1386	600		150/300	1
EXT002			2395	2404	600	3x44x195 C24	150/300	1
EXT003			2395	2404	600	3x44x195 C24	150/300	1
EXT004			2395	2404	600	2 x 3x44x195 C24	150/300	1
EXT005			2395	1200	600		150/300	1
EXT006			2395	2586	600		150/300	1
EXT007			2395	1890	600		150/300	1
EXT008			2395	460	600		150/300	1
EXT009			2395	1775	600		150/300	1
EXT010			2395	1227	600		150/300	1
EXT011			2395	460	600		150/300	1
EXT012			2395	1890	600		150/300	1
EXT013			2395	2400	600		150/300	1
EXT014			2395	2401	600		150/300	1
EXT015			2395	1200	600		150/300	1
EXT016			2395	2400	600		150/300	1
EXT017			2395	2400	600		150/300	1

Number	RevA	RevB	Height	Length	Centres	Lintels	Nailing	Quantity
EXT018			2395	1581	600		150/300	1
EXT019			2395	2400	600		150/300	1
EXT020			2395	2401	600	3x44x195 C24	150/300	1
EXT021			2395	1700	600		150/300	1
EXT025			348	2700	3000		150/300	1
EXT026			2395	1896	600	2x44x195 C24	150/300	1
EXT027			2395	2400	600		150/300	1
EXT028			2395	2180	600	2x44x195 C24	150/300	1
EXT029			2395	1201	600		150/300	1
EXT030			2395	2005	600		150/300	1
EXT031			2395	2665	600		150/300	1
EXT032			2395	1110	600		150/300	1
EXT033			2395	2401	600		150/300	1
EXT034			2395	2840	600	2x44x195 C24	150/300	1
EXT035			2395	2401	600		150/300	1
EXT036			2395	1001	600		150/300	1

IF IN DOUBT ASK

TIMBER FRAME MOVEMENT ALLOWANCE
ARCHITECT / BUILDING DESIGNER / BROCKARER TO ADJUST BRICK COURSE TO PROVIDE ADEQUATE GAP BELOW SILLS OF TIMBER FRAME OPENINGS TO ALLOW FOR SETTLEMENT AND SHRINKAGE OF THE TIMBER FRAME ESTIMATED TO BE -

GROUND FLOOR
FIRST FLOOR
SECOND FLOOR
ATTIC
EAVES

4mm
6mm
16mm
16mm

ARCHITECT / BUILDING DESIGNER TO DETAIL ABUTMENTS AND OPENINGS TO ACCOMMODATE MOVEMENT (REFER TO TRADA FOR MORE INFORMATION AND DETAILS).

COMPARTMENT TIES TO DOUBLE SKIN WALLS
COMPARTMENT WALL TIES CULLEN STR LIGHTWEIGHT STEEL STRAP (30mm x 2.5mm SECTION SIZE) x 250mm LG FIXED TO TOP RAIL OF WALL PANELS WITH MIN 4no 3.75mm dia x 50mm LG SQUARE THIST NAILS (2no PER PANEL) AT 1200mm C/C. STRAPS TO HAVE 4mm dia HOLES (THESE ARE TO BE SPECIFIED EXPLICITLY ON ORDER) STRAPS TO BE FIXED IN PAIRS

OPENINGS
ALL OPENING DIMENSIONS SHOWN ARE THE STRUCTURAL OPENING (S/O) SIZE. THESE FINISHES ARE NORMALLY OBTAINED FROM WINDOW SIZES. DIMENSIONS SHOWN ARE THE FINISHED DIMENSIONS. A SHIP OR OTHER SIDE AND OVER THE TOP OF THE WINDOW FRAME HAS BEEN ALLOWED FOR.

LEGAND
ALL EXTERNAL WALLS ARE 38x140mm O.S. EXTERNAL AND PARTY WALLS TO HAVE 95mm O.S.B (OR SIMILAR) NAILED TO CANTY SIDE AND COVERED WITH BREATHHER MEMBRANE. PARTY AND INTERNAL WALLS ARE 38x89mm O.S.
LOAD BEARING TIMBER WALL :
NONLOADBEARING TIMBER WALL :
EXTERNAL MASONRY WALL :
STRUCTURAL SUPPORT BEAM :
(BY OTHERS)

FINISHES
FINISHES SHOWN ARE INDICATIVE ONLY AND ARE PROVIDED TO ESTABLISH WORKING ZONES TO PROGRESS THE DETAILING OF THE TIMBER FRAME ELEMENTS. ACTUAL FINISHES SPECIFICATION FOR THERMAL, PRE AND ACOUSTIC PERFORMANCE TO BE PROVIDED BY OTHERS OR AS AGREED - ANY DIMENSIONAL VARIATIONS HOWEVER MAY IMPACT ON THE TIMBER FRAME COMPONENTS RESULTING IN REDUCTIONS TO THESE DETAILS.

MISCELLANEOUS
ALL DIMENSIONS ARE IN mm. DO NOT SCALE THIS DRAWING. CONTRACTOR TO CHECK ALL DIMENSIONS AND REPORT ALL ERRORS AND OMISSIONS TO THE ENGINEER.
THIS DRAWING IS TO BE READ IN CONJUNCTION WITH ALL OTHER STRUCTURAL, TIMBER DESIGN SERVICES, DRAWINGS AND DESIGN SPECIFICATION. ALL OTHER RELEVANT SERVICES, STRUCTURAL ENGINEERS DRAWINGS, ARCHITECTS / BUILDINGS DESIGNERS SPECIFICATION AND DRAWINGS AND NAILING SCHEDULE IN DESIGN SPECIFICATION.
ALL FININGS AND FITTINGS TO BE INSTALLED IN ACCORDANCE WITH MANUFACTURERS RECOMMENDATIONS.

ALL DIMENSIONS AND SETTING OUT TO BE CONFIRMED BY ARCHITECT / CLIENT.

Structural Timber Design Solutions LLP
Tel: 01225 877241 & 0179 517215
Fax: 01225 877242
Mobiles: 07831 817906 & 07831 727819

TRADA
Timber

Client: **

Title: GROUND FLOOR SITE PLAN

Project: **

Scale: 1:50@A3

Date stored: 24/04/2009

Drawn by: ANDY BEST

Checked by: PAUL NEWMAN

Date printed: 23/06/2009

Drawing No. **/G/02

Rev. A

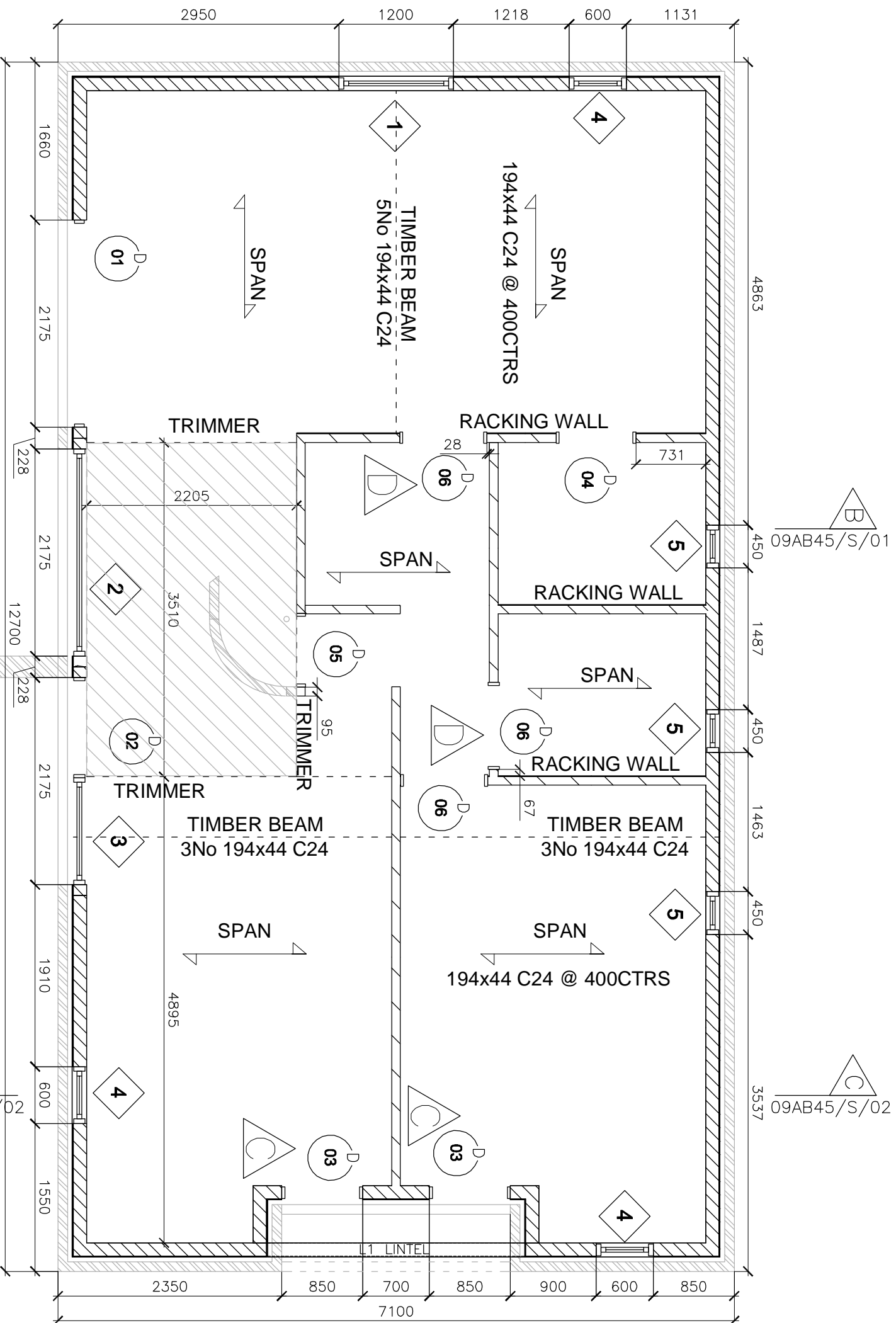

APERTURE SIZES T.B.C
HEAD HEIGHTS FROM F.F.L

WINDOW SCHEDULE

MARK	WIDTH	HEIGHT	Head	Quantity
1	1200	1050	2050	1
2	2175	2050	2050	1
3	1125	2050	2050	1
4	600	1050	2050	3
5	450	1050	2050	3

APERTURE SIZES T.B.C
DOOR HEIGHTS FROM F.F.L

DOOR SCHEDULE

MARK	Height	Width PR	Head	Quantity
1	2050	2175	2050	1
2	2050	1050	2050	1
3	2050	850	2050	2
4	2040	838	2040	1
5	2040	775	2040	1
6	2040	914	2040	3

GROUND FLOOR SETTING OUT PLAN

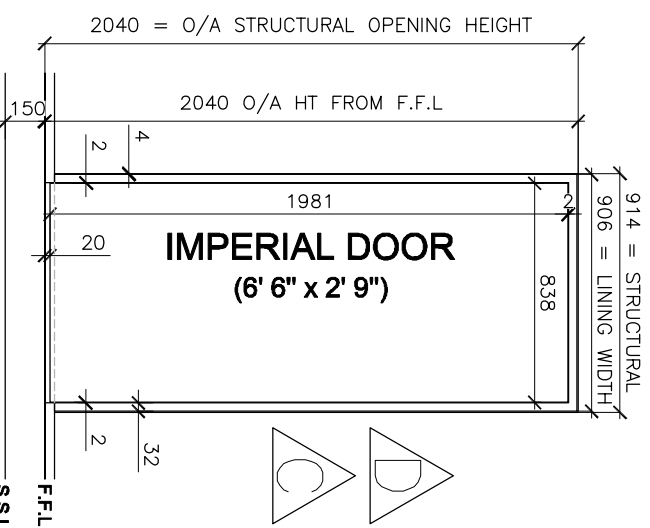

IF IN DOUBT ASK

TIMBER FRAME MOVEMENT ALLOWANCE
ARCHITECT / BUILDING DESIGNER / BRICKLAYER TO ADJUST BRICK COURSE TO PROVIDE ADEQUATE GAP BELOW SILLS OF TIMBER FRAME OPENINGS TO ALLOW FOR SETTLEMENT AND SHRINKAGE OF THE TIMBER FRAME ESTIMATED TO BE -

GROUND FLOOR 4mm
FIRST FLOOR 8mm
SECOND FLOOR 16mm
AT EAVES

ARCHITECT / BUILDING DESIGNER TO DETAIL ADJUSTMENTS AND OPENINGS TO ACCOMMODATE MOVEMENT (REFER TO TRADA FOR MORE INFORMATION AND DETAILS).

COMPARTMENT TIES TO DOUBLE SKIN WALLS

COMPARTMENT WALL TIES CULLEN 'STR' LIGHTWEIGHT STEEL STRAP (30mm x 2.5mm SECTION SIZE) x 250mm LG FIXED TO TOP RAIL OF WALL PANELS WITH MIN 4no 3.75mm dia x 50mm LG SQUARE TREST WALS (2no PER PANEL) AT 1200mm C/C STRAPS TO HAVE 4mm dia HOLES (THESE ARE TO BE SPECIFIED EXPLICITLY ON ORDER) STRAPS TO BE FIXED IN PAIRS

OPENINGS

ALL OPENING DIMENSIONS SHOWN ARE THE STRUCTURAL OPENING (G/O) SIZE. THESE FIGURES ARE NORMALLY OBTAINED FROM WINDOW SCHEDULES AND SHOULD BE CHECKED BY OTHERS PRIOR TO CONSTRUCTION. THE SIZE OF THE OPENING SHOULD BE CHECKED AGAINST THE WINDOW FRAME HAS BEEN ALLOWED FOR.

LEGEND

ALL EXTERNAL WALLS ARE 38x140mm C.S. EXTERNAL AND PARTY WALLS TO HAVE 95mm O.S.B (OR SIMILAR) NAILED TO PARTY SIDE AND COVERED WITH BREAKER MEMBRANE, PARTY AND INTERNAL WALLS ARE 38x89mm C.S.
LOAD BEARING TIMBER WALL :
NONLOAD BEARING TIMBER WALL :
EXTERNAL MASONRY WALL :
STRUCTURAL SUPPORT BEAM :
(BY OTHERS)

FINISHES

FINISHES SHOWN ARE INDICATIVE ONLY AND ARE PROVIDED TO ESTABLISH WORKING ZONES TO PROGRESS THE DETAILING OF THE TIMBER FRAME ELEMENTS. ACTUAL FINISHES SPECIFICATION FOR THERMAL, PRE AND ACOUSTIC PERFORMANCE TO BE PROVIDED BY OTHERS OR AS AGREED - ANY DIMENSIONAL VARIATIONS HOWEVER MAY IMPACT ON THE TIMBER FRAME COMPONENTS RESULTING IN REDUCTIONS TO THESE DETAILS.

MISCELLANEOUS

ALL DIMENSIONS ARE IN MM. DO NOT SCALE THIS DRAWING. CONTRACTOR TO CHECK ALL DIMENSIONS AND REPORT ALL ERRORS AND OMISSIONS TO THE ENGINEER.

THIS DRAWING IS TO BE READ IN CONJUNCTION WITH ALL OTHER STRUCTURAL, TIMBER DESIGN SERVICES, DRAWINGS AND DESIGN SPECIFICATION. ALL OTHER RELEVANT SERVICES, STRUCTURAL ENGINEERS DRAWINGS, ARCHITECTS / BUILDINGS DESIGNERS SPECIFICATION AND DRAWINGS AND MAILING SCHEDULE IN DESIGN SPECIFICATION.

ALL FININGS AND FITTINGS TO BE INSTALLED IN ACCORDANCE WITH MANUFACTURERS RECOMMENDATIONS.

ALL DIMENSIONS AND SETTING OUT TO BE CONFIRMED BY ARCHITECT / CLIENT.



Structural Timber Design Solutions LLP
21 LINDSAY ROAD, LONDON, WINDSOR, WINDSOR, WINDSOR, WINDSOR
Tel: 01725 877241 & 0179 517215
Mobiles: 07831 817906 & 07831 727819



FOR CONSTRUCTION

Structural Timber Design Solutions LLP is not responsible for building works carried out before this box states for construction.

Revision	Date	Comments
A	20/4/09	UPDATED SETTING OUT TO ENGINEERS SPECIFICATIONS
B	9/3/09	REVISED SETTING OUT TO SUIT 40FRAME
C	18/5/09	REV APERTURE HEIGHTS & SETTING OUT TO NEW FFL
D	19/5/09	DRAWING ISSUE STATUS & DOORS REVT TO SUIT BRIBBS

Client	**
Title	GROUND FLOOR SETTING OUT PLAN
Project	**
Scale	1:50@A3
Date issued	24/04/2009
Drawn by	ANDY BEST
Checked by	PAUL NEWMAN
Date printed	23/06/2009
Drawing No.	**/G/01
Rev.	D